

MDILink QX035 CSI2 TAP

Multi-Channel LVDS / Serial LVDS to dual 10GbE Measurement Interface

Along with **increasing sensor data rates (e.g. camera and radar data)**, the challenges of loss-free acquisition of raw data are also rising. The b-plus solution MDILink is located on the sensor end and enables **lossless decoupling of raw data** with time-stamps from a serial link/LVDS camera interface like CSI2, FPD or GMSL2.

For this purpose, the b-plus MDILink offers corresponding high-performance interfaces. The **logging of new and high-resolution sensor data** supports the further development of algorithms and thus supports the development of better ECU software. For a sensor manufacturer, this means **faster positioning on the market**.

In addition to **flexible programming**, the **hardware is also available in a modular design**. In addition to the standard variants, **customer-specific adaptations** can be implemented very effectively. Especially in the first prototyping developments you need a fast solution to realize projects faster.



Highlights

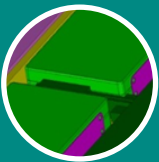

Modular design
for fast adaption
of customer need



Designed for high
bandwidth data
backchannel
communication

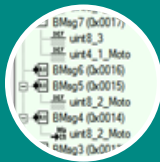

configuration
website for
flexible
programming



Robust design for
rough
environment



time
synchronization
IEEE1588
802.1AS

Technical Information MDILink QX035 CSI2 TAP 1CCT1CCT-2

Features

- 2x CSI2 Link in
- 2x CSI2 out (TAP mode)
- High performance SoC architecture
- 1GB RAM, 64MB Flash
- Modular concept for easy sensor adaption
- Up to 2x 10GbE download ports
- IEEE1588 802.1AS-2020 time synchronization
- robust and compact housing
- API for integration in 3rd party Framework¹
- 1GbE MGNT port for simple configuration
- Internal configuration space
- I2C backchannel communication & logging
- Data Integrity monitoring
- AVETO ready

Environment specification

Operating: -20 to 70°C

Non-Operating: -40 to 85°C

Humidity: 10% to 90%, non-condensing

Mechanical Dimensions (incl. mounting)

L x W x H[mm]: 159,7x140x38

IP20 (depends on connector)

Connector Specification

M12 Ethernet connectors for 1GbE / 10GbE

M12 Connector for MDILink power

Connector for CSI2 iPass+ HD Internal R/A

Power Supply

Nom. 8V to 32V, 6,5V crank-safe

Power consumption typ. 15W, max 25W.

external power on (ignition) control

¹ project based software adoption needed

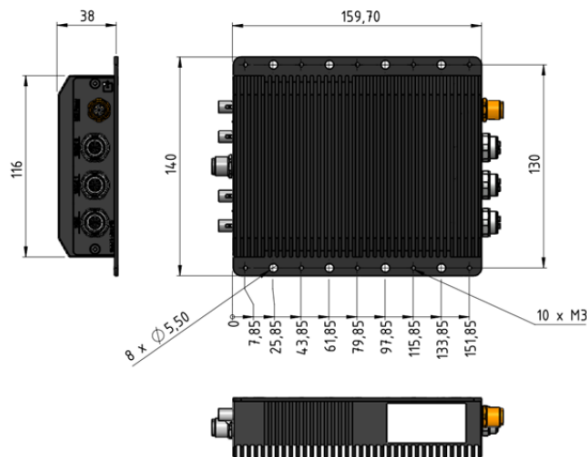
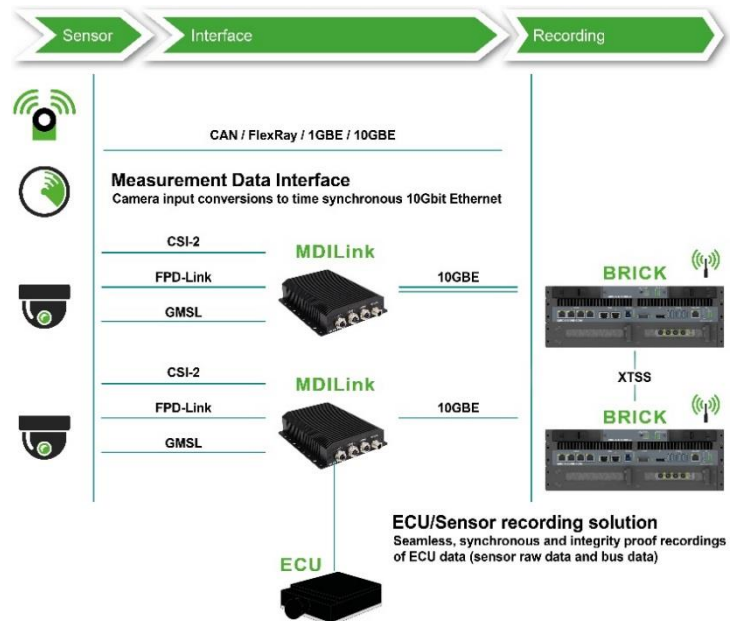

Name

MDILink QX035 CSI2 TAP
1CCT1CCT-2

Order-no.

B21671-MDI-001-0004

Description

Measurement Data Interface with flexible
Interface configuration
2x CSI2 TAP to 2x 10GbE
Including cables for power and Ethernet