

MDILink QX035

Multi-Channel LVDS / Serial LVDS to 10GbE Measurement Interface

Along with **increasing sensor data rates (e.g. camera and radar data)**, the challenges of loss-free acquisition of raw data are also rising. The b-plus solution MDILink is located on the sensor end and enables **lossless decoupling of raw data** with time-stamps from e.g. a serial link/LVDS camera interface.

For this purpose, the MDILink offers corresponding high-performance interfaces. The **logging of new and high-resolution sensor data** supports the further development of algorithms and thus supports the development of better ECU software. For a sensor manufacturer, this means **faster positioning on the market**.

In addition to **flexible programming**, the **hardware is also available in a modular design**. In addition to the standard variants, **customer-specific adaptations** can be implemented without any problems. Especially in the first prototyping developments you need a fast solution to realize projects faster.



Highlights

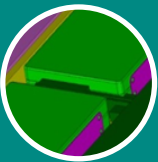

Modular design



Designed for high bandwidth data

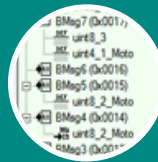

flexible programming



Robust design for vehicle use



Timestamp

Technical Information MDILink QX035-1FCT1FCT-1S

Features

- 2x FPD Link in
- 2x FPD Link out, TAP mode
- Modular concept for easy sensor adaption
- 1x 10GbE download ports (2x 10GbE opt.)
- Timestamp (need BRICK XTSS TR service)
- robust and compact housing for vehicle use
- API for integration in 3rd party Framework¹
- 1GbE LAN port for simple configuration¹
- Internal configuration space
- I2C communication logging
- Power over Coax (external supply)
- Data Integrity monitoring
- AVETO Recorder ready

Environment specification

Operating: -20 to 70°C tbd.

Non-Operating: -40 ~ 85°C

Humidity: 10% to 90%, non-condensing

Mechanical Dimensions (incl. mounting plate)

L x W x H[mm]: 159,7x140x38

IP20 (FAKRA connector version)

Connector Specification

M12 Ethernet connectors for 1GbE / 10GbE

M12 Connector for MDILink power

M12 Connector for PoC supply

FAKRA Serial Link Connector (project specific)

Power Supply

6V to 48V, crank-safe

Max. Power consumption 20-25W.

PoC (6 to 15V external supply depending on Sensor, no integrated filter or regulation)

¹Note

project based software adoption needed

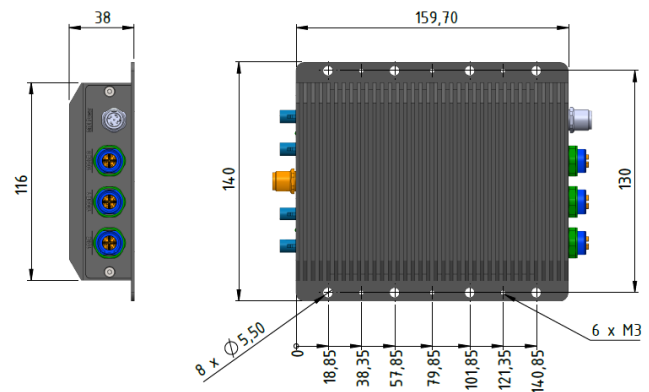
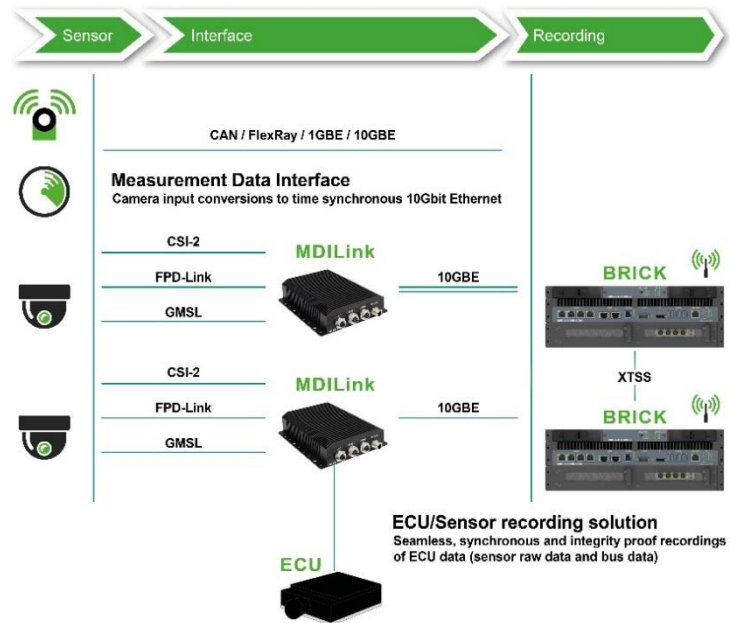

Name

MDILink QX035-1FCT1FCT-1S

Order-no.

Description

MDILink 2x FDP Link TAP to 10GbE

preliminary, is subject to change without prior notice

Alle Daten bei 25°C Umgebungstemperatur, falls nicht anders angegeben. / All data at nominal input and 25° C ambient temperature, if not marked otherwise. ▪ Alle Daten dienen nur Informationszwecken und sind nicht als zugesicherte Eigenschaften aufzufassen. / All data for information purposes only, no assured characteristics. ▪ Technische Änderungen ohne vorherige Ankündigung sowie Irrtümer vorbehalten. / Technical modifications without notice and errors reserved. ▪ Belastung mit Extremwerten über einen längeren Zeitraum kann die Zuverlässigkeit beeinflussen. / Strain with extreme values for a longer period may affect the reliability. ▪ Alle Trademarks und Logos sind Eigentum der jeweiligen Unternehmen. / All trademarks and logos are property of the concerning companies. In case of doubts the German version of the document is binding. © b-plus GmbH • Jun-18 • Version: 0.4